



# HEAD<sup>®</sup>-Master



**GROOVING TOOLS**

**STECHWERKZEUGE**



## Inhaltsverzeichnis Index

<b>MD-AXBL</b>	Einstech- und Längsdrehen (aussen) Grooving and turning (external)	Seite 4 Page 4
<b>MD-AXBR</b>	Einstech- und Längsdrehen (aussen) Grooving and turning (external)	Seite 5 Page 5
<b>MD-S-AXBL</b>	Einstech- und Längsdrehen (aussen) Grooving and turning (external)	Seite 6 Page 6
<b>MD-S-AXBR</b>	Einstech- und Längsdrehen (aussen) Grooving and turning (external)	Seite 7 Page 7
<b>MD-T-AXBL</b>	Einstechdrehen (aussen) Grooving (external)	Seite 8 Page 8
<b>MD-T-AXBR</b>	Einstechdrehen (aussen) Grooving (external)	Seite 9 Page 9
<b>MD-P-AXBL</b>	Eckenfreistechen (aussen) Grooving corner relief (external)	Seite 10 Page 10
<b>MD-P-AXBR</b>	Eckenfreistechen (aussen) Gooving corner relief (external)	Seite 11 Page 11
<b>MD-R-AXBL</b>	Axial- Einstechdrehen Face grooving	Seite 12 Page 12
<b>MD-R-AXBR</b>	Axial- Einstechdrehen Face grooving	Seite 13 Page 13
<b>MD-R90-AXBL</b>	Axial- Einstechdrehen Face grooving	Seite 14 Page 14
<b>MD-R90-AXBR</b>	Axial- Einstechdrehen Face grooving <sup>o</sup>	Seite 15 Page 15
	Wendeplatten Inserts	Seite 16 Page 16
<b>MD-IXBL</b>	Werkzeuge für Außenbearbeitung 45° External Turning Tool 45°	Seite 17 Page 17
<b>MD-IXBR</b>	Werkzeuge für Außenbearbeitung 95° External Turning Tool 95°	Seite 18 Page 18
	Technische Daten vc Technical data vc	Seite 19 Page 19
	Technische Daten f Technical data f	Seite 20 Page 20
	HM - Qualitäten HM - grades	Seite 21 Page 21
	Bearbeitungsbeispiel Example of work	Seite 22 Page 22

# Einstech- und Längsdrehen (aussen)

## Grooving and turning (external)

# MD-AXBL



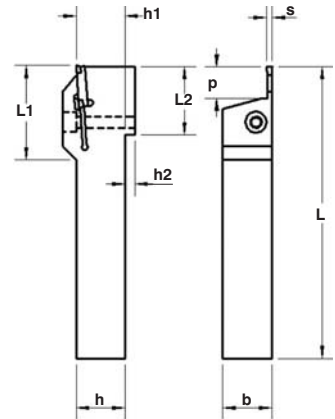

Made in Germany



Bestell-Nr. Order No.	Abmessungen - Dimension (mm)									Wendeplatte Insert
	h	h <sub>1</sub>	h <sub>2</sub>	b	p	s	L	L <sub>1</sub>	L <sub>2</sub>	
MD-AXBL 1212 -02	12	12	5	12	18	2	125	45	35	MD 22..
MD-AXBL 1212 -02,5	12	12	5	12	18	2,5	125	45	35	
MD-AXBL 1212 -03	12	12	5	12	18	3	125	45	35	
MD-AXBL 1212 -04	12	12	5	12	19	4	125	45	35	MD 24..
MD-AXBL 1616 -02	16	16		16	18	2	125	45		MD 22..
MD-AXBL 1616 -02,5	16	16		16	18	2,5	125	45		
MD-AXBL 1616 -03	16	16		16	18	3	125	45		
MD-AXBL 1616 -04	16	16		16	19	4	125	45		MD 24..
MD-AXBL 2020 -02	20	20		20	18	2	125	45		MD 22..
MD-AXBL 2020 -02,5	20	20		20	18	2,5	125	45		
MD-AXBL 2020 -03	20	20		20	18	3	125	45		
MD-AXBL 2020 -04	20	20		20	19	4	125	45		MD 24..
MD-AXBL 2020 -05	20	20		20	19	5	125	45		
MD-AXBL 2020 -06	20	20		20	19	6	125	45		
MD-AXBL 2525 -02	25	25		25	18	2	150	45		MD 22..
MD-AXBL 2525 -02,5	25	25		25	18	2,5	150	45		
MD-AXBL 2525 -03	25	25		25	18	3	150	45		
MD-AXBL 2525 -04	25	25		25	19	4	150	45		MD 24..
MD-AXBL 2525 -05	25	25		25	19	5	150	45		
MD-AXBL 2525 -06	25	25		25	19	6	150	45		
MD-AXBL 3225 -05	32	32		25	19	5	170	45		MD 24..
MD-AXBL 3225 -06	32	32		25	19	6	170	45		

Ersatzteile Halter ..1212: Schraube M5; Schlüssel I4;  
Halter ab ..1616: Schraube M6; Schlüssel I5

Spare Parts Tool ..1212: Screw M5; Key I4;  
Tool ab ..1616: Screw M6; Key I5

Bestell-Nr. Order No.	Bezeichnung Designation	Abmessungen - Dimension (mm)				PVD-TIALN	PVD-TIALN	CVD
		Länge length	Breite width	Radius	ap max.	KTE20	PTV28	PTT28
	MD 22N 2.00S-0.20-T	22.0	2.00	0.20	1.50	●	●	●
	MD 22N 2.50S-0.20-T	22.0	2.50	0.20	2.00	●	●	●
	MD 22N 3.00S-0.30-T	22.0	3.00	0.30	2.50	●	●	●
	MD 24N 4.00S-0.40-T	24.0	4.00	0.40	3.00	●	●	●
	MD 24N 5.00S-0.40-T	24.0	5.00	0.40	3.50	●	●	●
	MD 24N 6.00S-0.40-T	24.0	6.00	0.40	4.00	●	●	●
	MD 22N 3.00S-1.50-R	22.0	3.00	1.50	3.00	●	●	●
	MD 24N 4.00S-2.00-R	24.0	4.00	2.00	4.00	●	●	●
	MD 24N 6.00S-3.00-R	24.0	6.00	3.00	5.00	●	●	●

# Einstech- und Längsdrehen (ausßen) Grooving and turning (external)

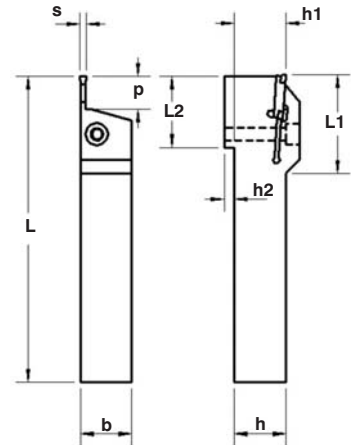

## MD-AXBR



Bestell-Nr. Order No.	Abmessungen - Dimension (mm)									Wendeplatte Insert
	h	h <sub>1</sub>	h <sub>2</sub>	b	p	s	L	L <sub>1</sub>	L <sub>2</sub>	
MD-AXBR 1212 -02	12	12	5	12	18	2	125	45	35	MD 22..
MD-AXBR 1212 -02,5	12	12	5	12	18	2,5	125	45	35	
MD-AXBR 1212 -03	12	12	5	12	18	3	125	45	35	
MD-AXBR 1212 -04	12	12	5	12	19	4	125	45	35	MD 24..
MD-AXBR 1616 -02	16	16		16	18	2	125	45		MD 22..
MD-AXBR 1616 -02,5	16	16		16	18	2,5	125	45		
MD-AXBR 1616 -03	16	16		16	18	3	125	45		
MD-AXBR 1616 -04	16	16		16	19	4	125	45		MD 24..
MD-AXBR 2020 -02	20	20		20	18	2	125	45		MD 22..
MD-AXBR 2020 -02,5	20	20		20	18	2,5	125	45		
MD-AXBR 2020 -03	20	20		20	18	3	125	45		
MD-AXBR 2020 -04	20	20		20	19	4	125	45		MD 24..
MD-AXBR 2020 -05	20	20		20	19	5	125	45		
MD-AXBR 2020 -06	20	20		20	19	6	125	45		
MD-AXBR 2525 -02	25	25		25	18	2	150	45		MD 22..
MD-AXBR 2525 -02,5	25	25		25	18	2,5	150	45		
MD-AXBR 2525 -03	25	25		25	18	3	150	45		
MD-AXBR 2525 -04	25	25		25	19	4	150	45		MD 24..
MD-AXBR 2525 -05	25	25		25	19	5	150	45		
MD-AXBR 2525 -06	25	25		25	19	6	150	45		
MD-AXBR 3225 -05	32	32		25	19	5	170	45		MD 24..
MD-AXBR 3225 -06	32	32		25	19	6	170	45		

Ersatzteile Halter ..1212: Schraube M5; Schlüssel I4;  
Halter ab ..1616: Schraube M6; Schlüssel I5

Spare Parts Tool ..1212: Screw M5; Key I4;  
Tool ab ..1616: Screw M6; Key I5

Bestell-Nr. Order No.	Bezeichnung Designation	Abmessungen - Dimension (mm)				PVD-TIALN	PVD-TIALN	CVD
		Länge length	Breite width	Radius	ap max.	KTE20	PTV28	PTT28
	MD 22N 2.00S-0.20-T	22.0	2.00	0.20	1.50	●	●	●
	MD 22N 2.50S-0.20-T	22.0	2.50	0.20	2.00	●	●	●
	MD 22N 3.00S-0.30-T	22.0	3.00	0.30	2.50	●	●	●
	MD 24N 4.00S-0.40-T	24.0	4.00	0.40	3.00	●	●	●
	MD 24N 5.00S-0.40-T	24.0	5.00	0.40	3.50	●	●	●
	MD 24N 6.00S-0.40-T	24.0	6.00	0.40	4.00	●	●	●
	MD 22N 3.00S-1.50-R	22.0	3.00	1.50	3.00	●	●	●
	MD 24N 4.00S-2.00-R	24.0	4.00	2.00	4.00	●	●	●
	MD 24N 6.00S-3.00-R	24.0	6.00	3.00	5.00	●	●	●

# Einstech- und Längsdrehen (aussen)

## Grooving and turning (external)

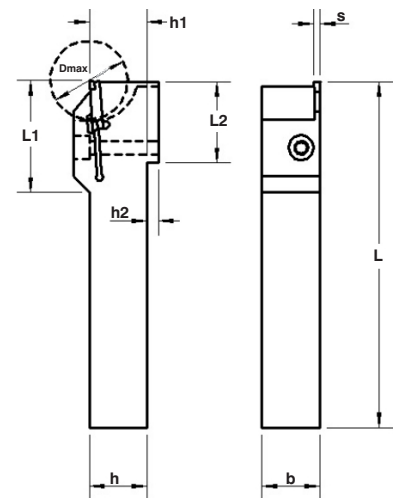

# MD-S-AXBL



Bestell-Nr. Order No.	Abmessungen - Dimension (mm)									Wendeplatte Insert
	h	h <sub>1</sub>	h <sub>2</sub>	b	D <sub>max</sub>	s	L	L <sub>1</sub>	L <sub>2</sub>	
MD-S-AXBL 1212 -02	12	12	5	12	36	2	125	45	35	MD 22..
MD-S-AXBL 1212 -02,5	12	12	5	12	36	2,5	125	45	35	
MD-S-AXBL 1212 -03	12	12	5	12	36	3	125	45	35	
MD-S-AXBL 1616 -02	16	16		16	36	2	125	45		
MD-S-AXBL 1616 -02,5	16	16		16	36	2,5	125	45		
MD-S-AXBL 1616 -03	16	16		16	36	3	125	45		
MD-S-AXBL 2020 -02	20	20		20	36	2	125	45		MD 24..
MD-S-AXBL 2020 -02,5	20	20		20	36	2,5	125	45		
MD-S-AXBL 2020 -03	20	20		20	36	3	125	45		
MD-S-AXBL 2020 -04	20	20		20	38	4	125	45		MD 24..
MD-S-AXBL 2020 -05	20	20		20	38	5	125	45		
MD-S-AXBL 2020 -06	20	20		20	38	6	125	45		
MD-S-AXBL 2525 -02	25	25		25	36	2	150	45		MD 22..
MD-S-AXBL 2525 -02,5	25	25		25	36	2,5	150	45		
MD-S-AXBL 2525 -03	25	25		25	36	3	150	45		
MD-S-AXBL 2525 -04	25	25		25	38	4	150	45		MD 24..
MD-S-AXBL 2525 -05	25	25		25	38	5	150	45		
MD-S-AXBL 2525 -06	25	25		25	38	6	150	45		
MD-S-AXBL 3225 -05	32	32		25	38	5	170	45		
MD-S-AXBL 3225 -06	32	32		25	38	6	170	45		

Ersatzteile Halter ..1212: Schraube M5; Schlüssel I4;  
Halter ab ..1616: Schraube M6; Schlüssel I5

Spare Parts Tool ..1212: Screw M5; Key I4;  
Tool ab ..1616: Screw M6; Key I5

Bestell-Nr. Order No.	Abmessungen - Dimension (mm)					PVD-TIALN	PVD-TIALN	CVD
	Bezeichnung Designation	Länge length	Breite width	Radius	ap max.	KTE20	PTV28	PTT28
	MD 22N 2.00S-0.20-T	22.0	2.00	0.20	1.50	●	●	●
	MD 22N 2.50S-0.20-T	22.0	2.50	0.20	2.00	●	●	●
	MD 22N 3.00S-0.30-T	22.0	3.00	0.30	2.50	●	●	●
	MD 24N 4.00S-0.40-T	24.0	4.00	0.40	3.00	●	●	●
	MD 24N 5.00S-0.40-T	24.0	5.00	0.40	3.50	●	●	●
	MD 24N 6.00S-0.40-T	24.0	6.00	0.40	4.00	●	●	●
	MD 22N 3.00S-1.50-R	22.0	3.00	1.50	3.00	●	●	●
	MD 24N 4.00S-2.00-R	24.0	4.00	2.00	4.00	●	●	●
	MD 24N 6.00S-3.00-R	24.0	6.00	3.00	5.00	●	●	●

# Einsteich- und Längsdrehen (ausßen) Grooving and turning (external)

## MD-S-AXBR

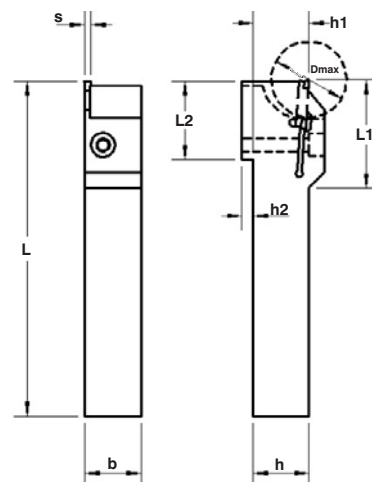

Bestell-Nr. Order No.	Abmessungen - Dimension (mm)									Wendeplatte Insert
	h	h <sub>1</sub>	h <sub>2</sub>	b	D <sub>max</sub>	s	L	L <sub>1</sub>	L <sub>2</sub>	
MD-S-AXBR 1212 -02	12	12	5	12	36	2	125	45	35	MD 22..
MD-S-AXBR 1212 -02,5	12	12	5	12	36	2,5	125	45	35	
MD-S-AXBR 1212 -03	12	12	5	12	36	3	125	45	35	
MD-S-AXBR 1616 -02	16	16		16	36	2	125	45		
MD-S-AXBR 1616 -02,5	16	16		16	36	2,5	125	45		
MD-S-AXBR 1616 -03	16	16		16	36	3	125	45		
MD-S-AXBR 2020 -02	20	20		20	36	2	125	45		MD 24..
MD-S-AXBR 2020 -02,5	20	20		20	36	2,5	125	45		
MD-S-AXBR 2020 -03	20	20		20	36	3	125	45		
MD-S-AXBR 2020 -04	20	20		20	38	4	125	45		
MD-S-AXBR 2020 -05	20	20		20	38	5	125	45		MD 24..
MD-S-AXBR 2020 -06	20	20		20	38	6	125	45		
MD-S-AXBR 2525 -02	25	25		25	36	2	150	45		MD 22..
MD-S-AXBR 2525 -02,5	25	25		25	36	2,5	150	45		
MD-S-AXBR 2525 -03	25	25		25	36	3	150	45		MD 24..
MD-S-AXBR 2525 -04	25	25		25	38	4	150	45		
MD-S-AXBR 2525 -05	25	25		25	38	5	150	45		
MD-S-AXBR 2525 -06	25	25		25	38	6	150	45		
MD-S-AXBR 3225 -05	32	32		25	38	5	170	45		
MD-S-AXBR 3225 -06	32	32		25	38	6	170	45		

Ersatzteile Halter ..1212: Schraube M5; Schlüssel I4;  
Halter ab ..1616: Schraube M6; Schlüssel I5

Spare Parts Tool ..1212: Screw M5; Key I4;  
Tool ab ..1616: Screw M6; Key I5

Bestell-Nr. Order No.	Abmessungen - Dimension (mm)					PVD-TIALN	PVD-TIALN	CVD
	Bezeichnung Designation	Länge length	Breite width	Radius	ap max.	KTE20	PTV28	PTT28
	MD 22N 2.00S-0.20-T	22.0	2.00	0.20	1.50	●	●	●
	MD 22N 2.50S-0.20-T	22.0	2.50	0.20	2.00	●	●	●
	MD 22N 3.00S-0.30-T	22.0	3.00	0.30	2.50	●	●	●
	MD 24N 4.00S-0.40-T	24.0	4.00	0.40	3.00	●	●	●
	MD 24N 5.00S-0.40-T	24.0	5.00	0.40	3.50	●	●	●
	MD 24N 6.00S-0.40-T	24.0	6.00	0.40	4.00	●	●	●
	MD 22N 3.00S-1.50-R	22.0	3.00	1.50	3.00	●	●	●
	MD 24N 4.00S-2.00-R	24.0	4.00	2.00	4.00	●	●	●
	MD 24N 6.00S-3.00-R	24.0	6.00	3.00	5.00	●	●	●

# Einstechdrehen (aussen)

## Grooving (external)

# MD-T-AXBL

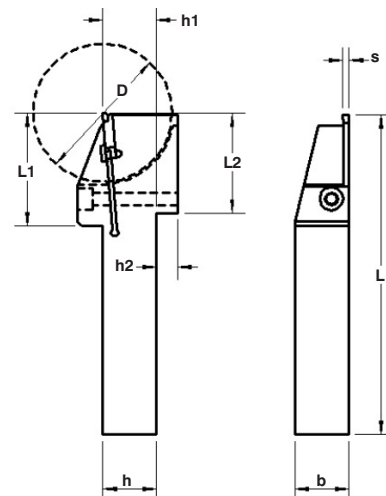
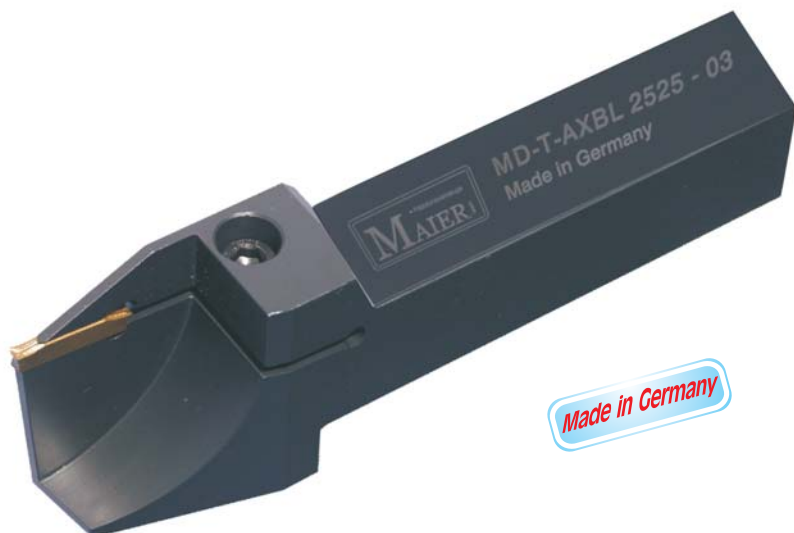

Bestell-Nr. Order No.	Abmessungen - Dimension (mm)									Wendeplatte Insert
	D	h	h <sub>1</sub>	h <sub>2</sub>	b	s	L	L <sub>1</sub>	L <sub>2</sub>	
MD-T-AXBL 2020 -03	65	20	20	17	20	3	125	55	45	MD 22...-1
MD-T-AXBL 2020 -04	65	20	20	17	20	4	125	55	45	
MD-T-AXBL 2020 -05	80	20	20	18	20	5	150	60	50	MD 24...-1
MD-T-AXBL 2020 -06	80	20	20	18	20	6	150	60	50	
MD-T-AXBL 2525 -03	65	25	25	12	25	3	150	55	45	MD 22...-1
MD-T-AXBL 2525 -04	65	25	25	12	25	4	150	55	45	
MD-T-AXBL 2525 -05	80	25	25	18	25	5	160	60	50	MD 24...-1
MD-T-AXBL 2525 -06	80	25	25	18	25	6	160	60	50	

Ersatzteile Schraube M6; Schlüssel I5

Spare Parts Screw M6; Key I5

Bestell-Nr. Order No.	Bezeichnung Designation	Abmessungen - Dimension (mm)				PVD-TIALN	PVD-TIALN	CVD
		Länge length	Breite width	Radius	ap max.	KTE20	PTV28	PTT28
	MD 22N 2.00S-0.20-T-1	22.0	2.00	0.20	1.50	●	●	●
	MD 22N 2.50S-0.20-T-1	22.0	2.50	0.20	2.00	●	●	●
	MD 22N 3.00S-0.30-T-1	22.0	3.00	0.30	2.50	●	●	●
	MD 24N 4.00S-0.40-T-1	24.0	4.00	0.40	3.00	●	●	●
	MD 24N 5.00S-0.40-T-1	24.0	5.00	0.40	3.50	●	●	●
	MD 24N 6.00S-0.40-T-1	24.0	6.00	0.40	4.00	●	●	●
	MD 22N 3.00S-1.50-R-1	22.0	3.00	1.50	3.00	●	●	●
	MD 24N 4.00S-2.00-R-1	24.0	4.00	2.00	4.00	●	●	●
	MD 24N 6.00S-3.00-R-1	24.0	6.00	3.00	5.00	●	●	●

### Empfehlung:

Bis Stech-Durchmesser 34 kann zweischneidige Wendeplatte MD.. eingesetzt werden.  
Ab Durchmesser 34 sind MD...-1 einzusetzen.



# MD-T-AXBR

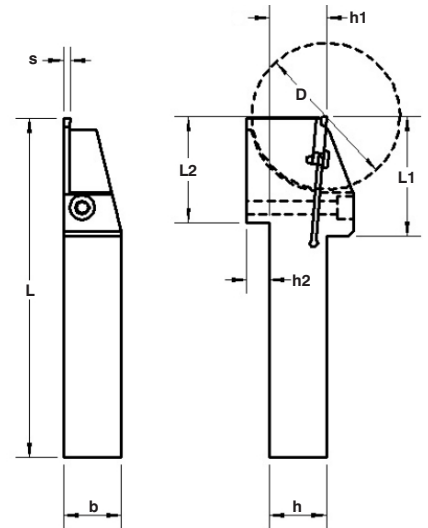

Bestell-Nr. Order No.	Abmessungen - Dimension (mm)									Wendeplatte Insert
	D	h	h <sub>1</sub>	h <sub>2</sub>	b	s	L	L <sub>1</sub>	L <sub>2</sub>	
MD-T-AXBR 2020 -03	65	20	20	17	20	3	125	55	45	MD 22...-1
MD-T-AXBR 2020 -04	65	20	20	17	20	4	125	55	45	
MD-T-AXBR 2020 -05	80	20	20	18	20	5	150	60	50	MD 24...-1
MD-T-AXBR 2020 -06	80	20	20	18	20	6	150	60	50	
MD-T-AXBR 2525 -03	65	25	25	12	25	3	150	55	45	MD 22...-1
MD-T-AXBR 2525 -04	65	25	25	12	25	4	150	55	45	
MD-T-AXBR 2525 -05	80	25	25	18	25	5	160	60	50	MD 24...-1
MD-T-AXBR 2525 -06	80	25	25	18	25	6	160	60	50	

Ersatzteile Schraube M6; Schlüssel I5

Spare Parts Screw M6; Key I5

Bestell-Nr. Order No.	Bezeichnung Designation	Abmessungen - Dimension (mm)				PVD-TIALN	PVD-TIALN	CVD
		Länge length	Breite width	Radius	ap max.	KTE20	PTV28	PTT28
	MD 22N 2.00S-0.20-T-1	22.0	2.00	0.20	1.50	●	●	●
	MD 22N 2.50S-0.20-T-1	22.0	2.50	0.20	2.00	●	●	●
	MD 22N 3.00S-0.30-T-1	22.0	3.00	0.30	2.50	●	●	●
	MD 24N 4.00S-0.40-T-1	24.0	4.00	0.40	3.00	●	●	●
	MD 24N 5.00S-0.40-T-1	24.0	5.00	0.40	3.50	●	●	●
	MD 24N 6.00S-0.40-T-1	24.0	6.00	0.40	4.00	●	●	●
	MD 22N 3.00S-1.50-R-1	22.0	3.00	1.50	3.00	●	●	●
	MD 24N 4.00S-2.00-R-1	24.0	4.00	2.00	4.00	●	●	●
	MD 24N 6.00S-3.00-R-1	24.0	6.00	3.00	5.00	●	●	●

**Empfehlung:**

Bis Stech-Durchmesser 34 kann zweischneidige Wendeplatte MD.. eingesetzt werden.  
Ab Durchmesser 34 sind MD...-1 einzusetzen.

# Eckenfreistechen (aussen)

## Grooving corner relief (external)

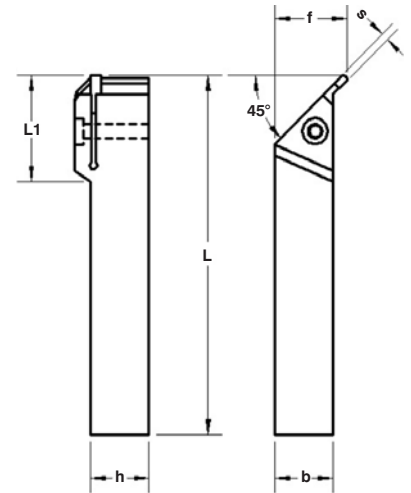

# MD-P-AXBL



Bestell-Nr. Order No.	Abmessungen - Dimension (mm)							Wendeplatte Insert
	h	b	f	p <sub>max</sub>	s	L	L <sub>1</sub>	
MD-P-AXBL 1616 -03	16	16	22	1	3	125	45	MD 22..
MD-P-AXBL 1616 -04	16	16	22	1,5	4	125	45	
MD-P-AXBL 1616 -05	16	16	22	2	5	125	45	MD 24..
MD-P-AXBL 1616 -06	16	16	22	2	6	125	45	
MD-P-AXBL 2020 -03	20	20	26	1	3	125	45	MD 22..
MD-P-AXBL 2020 -04	20	20	26	1,5	4	125	45	
MD-P-AXBL 2020 -05	20	20	26	2	5	125	45	MD 24..
MD-P-AXBL 2020 -06	20	20	26	2	6	125	45	
MD-P-AXBL 2525 -03	25	25	31	1	3	150	45	MD 22..
MD-P-AXBL 2525 -04	25	25	31	1,5	4	150	45	
MD-P-AXBL 2525 -05	25	25	31	2	5	150	45	MD 24..
MD-P-AXBL 2525 -06	25	25	31	2	6	150	45	

Ersatzteile Schraube M6; Schlüssel I5

Spare Parts Screw M6; Key I5

Bestell-Nr. Order No.	Bezeichnung Designation	Abmessungen - Dimension (mm)				PVD-TIALN	PVD-TIALN	CVD
		Länge length	Breite width	Radius	ap max.	KTE20	PTV28	PTT28
	MD 22N 2.00S-0.20-T	22.0	2.00	0.20	1.50	●	●	●
	MD 22N 2.50S-0.20-T	22.0	2.50	0.20	2.00	●	●	●
	MD 22N 3.00S-0.30-T	22.0	3.00	0.30	2.50	●	●	●
	MD 24N 4.00S-0.40-T	24.0	4.00	0.40	3.00	●	●	●
	MD 24N 5.00S-0.40-T	24.0	5.00	0.40	3.50	●	●	●
	MD 24N 6.00S-0.40-T	24.0	6.00	0.40	4.00	●	●	●
	MD 22N 3.00S-1.50-R	22.0	3.00	1.50	3.00	●	●	●
	MD 24N 4.00S-2.00-R	24.0	4.00	2.00	4.00	●	●	●
	MD 24N 6.00S-3.00-R	24.0	6.00	3.00	5.00	●	●	●

# Eckenfreistechen (aussen) Grooving corner relief (external)

## MD-P-AXBR

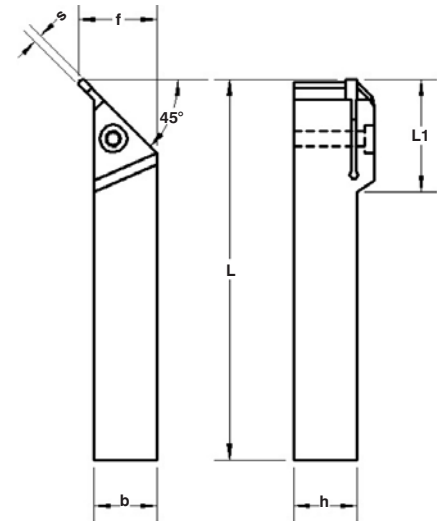

Bestell-Nr. Order No.	Abmessungen - Dimension (mm)							Wendeplatte Insert
	h	b	f	p <sub>max</sub>	s	L	L <sub>1</sub>	
MD-P-AXBR 1616 -03	16	16	22	1	3	125	45	MD 22..
MD-P-AXBR 1616 -04	16	16	22	1,5	4	125	45	
MD-P-AXBR 1616 -05	16	16	22	2	5	125	45	MD 24..
MD-P-AXBR 1616 -06	16	16	22	2	6	125	45	
MD-P-AXBR 2020 -03	20	20	26	1	3	125	45	MD 22..
MD-P-AXBR 2020 -04	20	20	26	1,5	4	125	45	
MD-P-AXBR 2020 -05	20	20	26	2	5	125	45	MD 24..
MD-P-AXBR 2020 -06	20	20	26	2	6	125	45	
MD-P-AXBR 2525 -03	25	25	31	1	3	150	45	MD 22..
MD-P-AXBR 2525 -04	25	25	31	1,5	4	150	45	
MD-P-AXBR 2525 -05	25	25	31	2	5	150	45	MD 24..
MD-P-AXBR 2525 -06	25	25	31	2	6	150	45	

Ersatzteile Schraube M6; Schlüssel I5

Spare Parts Screw M6; Key I5

Bestell-Nr. Order No.	Bezeichnung Designation	Abmessungen - Dimension (mm)				PVD-TIALN	PVD-TIALN	CVD
		Länge length	Breite width	Radius	ap max.	KTE20	PTV28	PTT28
	MD 22N 2.00S-0.20-T	22.0	2.00	0.20	1.50	●	●	●
	MD 22N 2.50S-0.20-T	22.0	2.50	0.20	2.00	●	●	●
	MD 22N 3.00S-0.30-T	22.0	3.00	0.30	2.50	●	●	●
	MD 24N 4.00S-0.40-T	24.0	4.00	0.40	3.00	●	●	●
	MD 24N 5.00S-0.40-T	24.0	5.00	0.40	3.50	●	●	●
	MD 24N 6.00S-0.40-T	24.0	6.00	0.40	4.00	●	●	●
	MD 22N 3.00S-1.50-R	22.0	3.00	1.50	3.00	●	●	●
	MD 24N 4.00S-2.00-R	24.0	4.00	2.00	4.00	●	●	●
	MD 24N 6.00S-3.00-R	24.0	6.00	3.00	5.00	●	●	●

# Axial- Einstechdrehen

## Face grooving

# MD-R-AXBL

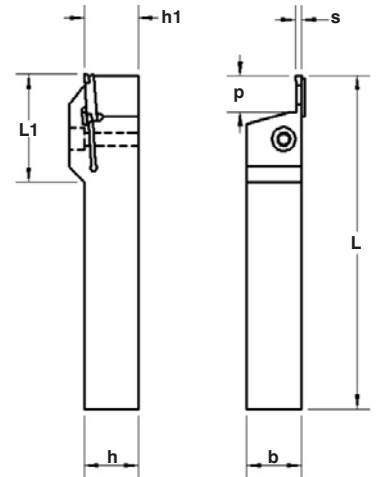

Bestell-Nr. Order No.	Abmessungen - Dimension (mm)								Wendeplatte Insert
	h	h <sub>1</sub>	b	D <sub>min</sub> -D <sub>max</sub>	p	s	L	L <sub>1</sub>	
MD-R-AXBL 2020-03.25	20	20	20	19-30	18	3	125	45	MD 22..
MD-R-AXBL 2020-03.30	20	20	20	24-38	18	3	125	45	
MD-R-AXBL 2020-03.38	20	20	20	32-48	18	3	125	45	
MD-R-AXBL 2020-03.48	20	20	20	42-60	18	3	125	45	
MD-R-AXBL 2020-03.60	20	20	20	54-75	18	3	125	45	
MD-R-AXBL 2020-03.75	20	20	20	69-100	18	3	125	45	
MD-R-AXBL 2020-03.100	20	20	20	94-200	18	3	125	45	
MD-R-AXBL 2020-04.34	20	20	20	26-34	19	4	125	45	MD 24..
MD-R-AXBL 2020-04.40	20	20	20	32-40	19	4	125	45	
MD-R-AXBL 2020-04.48	20	20	20	40-48	19	4	125	45	
MD-R-AXBL 2020-04.60	20	20	20	52-60	19	4	125	45	
MD-R-AXBL 2020-04.75	20	20	20	67-150	19	4	125	45	
MD-R-AXBL 2020-04.150	20	20	20	142-450	19	4	125	45	
MD-R-AXBL 2020-05.42	20	20	20	32-55	19	5	125	45	
MD-R-AXBL 2020-05.55	20	20	20	45-75	19	5	125	45	
MD-R-AXBL 2020-05.75	20	20	20	65-150	19	5	125	45	
MD-R-AXBL 2525-03.25	25	25	25	19-30	18	3	150	45	MD 22..
MD-R-AXBL 2525-03.30	25	25	25	24-38	18	3	150	45	
MD-R-AXBL 2525-03.38	25	25	25	32-48	18	3	150	4	
MD-R-AXBL 2525-03.48	25	25	25	42-60	18	3	150	45	
MD-R-AXBL 2525-03.60	25	25	25	54-75	18	3	150	45	
MD-R-AXBL 2525-03.75	25	25	25	69-100	18	3	150	45	
MD-R-AXBL 2525-03.100	25	25	25	94-150	18	3	150	45	
MD-R-AXBL 2525-04.34	25	25	25	26-40	19	4	150	45	MD 24..
MD-R-AXBL 2525-04.40	25	25	25	32-48	19	4	150	45	
MD-R-AXBL 2525-04.48	25	25	25	40-60	19	4	150	45	
MD-R-AXBL 2525-04.60	25	25	25	52-75	19	4	150	45	
MD-R-AXBL 2525-04.75	25	25	25	67-150	19	4	150	45	
MD-R-AXBL 2525-04.150	25	25	25	142-450	19	4	150	45	
MD-R-AXBL 2525-04.450	25	25	25	442-∞	19	4	150	45	
MD-R-AXBL 2525-05.42	25	25	25	32-55	19	5	150	45	
MD-R-AXBL 2525-05.55	25	25	25	45-75	19	5	150	45	
MD-R-AXBL 2525-05.75	25	25	25	65-130	19	5	150	45	
MD-R-AXBL 2525-05.130	25	25	25	120-200	19	5	150	45	
MD-R-AXBL 2525-05.200	25	25	25	190-450	19	5	150	45	
MD-R-AXBL 2525-05.450	25	25	25	440-∞	19	5	150	45	

Ersatzteile Schraube M6; Schlüssel I5

Spare Parts Screw M6; Key I5

Wendeplatten Seite 16

# MD-R-AXBR

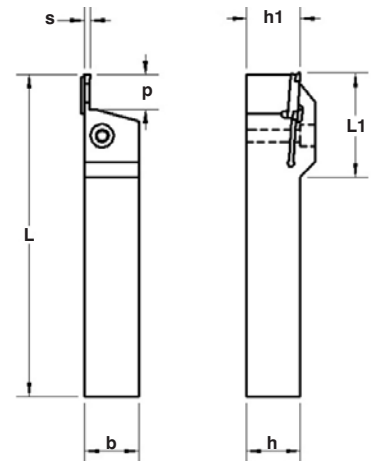

Bestell-Nr. Order No.	Abmessungen - Dimension (mm)								Wendeplatte Insert
	h	h <sub>1</sub>	b	D <sub>min</sub> -D <sub>max</sub>	p	s	L	L <sub>1</sub>	
MD-R-AXBR 2020-03.25	20	20	20	19-30	18	3	125	45	MD 22..
MD-R-AXBR 2020-03.30	20	20	20	24-38	18	3	125	45	
MD-R-AXBR 2020-03.38	20	20	20	32-48	18	3	125	45	
MD-R-AXBR 2020-03.48	20	20	20	42-60	18	3	125	45	
MD-R-AXBR 2020-03.60	20	20	20	54-75	18	3	125	45	
MD-R-AXBR 2020-03.75	20	20	20	69-100	18	3	125	45	
MD-R-AXBR 2020-03.100	20	20	20	94-200	18	3	125	45	
MD-R-AXBR 2020-04.34	20	20	20	26-40	19	4	125	45	MD 24..
MD-R-AXBR 2020-04.40	20	20	20	32-48	19	4	125	45	
MD-R-AXBR 2020-04.48	20	20	20	40-60	19	4	125	45	
MD-R-AXBR 2020-04.60	20	20	20	52-75	19	4	125	45	
MD-R-AXBR 2020-04.75	20	20	20	67-150	19	4	125	45	
MD-R-AXBR 2020-04.150	20	20	20	142-450	19	4	125	45	
MD-R-AXBR 2020-05.42	20	20	20	32-55	19	5	125	45	
MD-R-AXBR 2020-05.55	20	20	20	45-75	19	5	125	45	
MD-R-AXBR 2020-05.75	20	20	20	65-150	19	5	125	45	
MD-R-AXBR 2525-03.25	25	25	25	19-30	18	3	150	45	MD 22..
MD-R-AXBR 2525-03.30	25	25	25	24-38	18	3	150	45	
MD-R-AXBR 2525-03.38	25	25	25	32-48	18	3	150	4	
MD-R-AXBR 2525-03.48	25	25	25	42-60	18	3	150	45	
MD-R-AXBR 2525-03.60	25	25	25	54-75	18	3	150	45	
MD-R-AXBR 2525-03.75	25	25	25	69-100	18	3	150	45	
MD-R-AXBR 2525-03.100	25	25	25	94-200	18	3	150	45	
MD-R-AXBR 2525-04.34	25	25	25	26-40	19	4	150	45	MD 24..
MD-R-AXBR 2525-04.40	25	25	25	32-48	19	4	150	45	
MD-R-AXBR 2525-04.48	25	25	25	40-60	19	4	150	45	
MD-R-AXBR 2525-04.60	25	25	25	52-75	19	4	150	45	
MD-R-AXBR 2525-04.75	25	25	25	67-150	19	4	150	45	
MD-R-AXBR 2525-04.150	25	25	25	142-450	19	4	150	45	
MD-R-AXBR 2525-04.450	25	25	25	442-∞	19	4	150	45	
MD-R-AXBR 2525-05.42	25	25	25	32-55	19	5	150	45	
MD-R-AXBR 2525-05.55	25	25	25	45-75	19	5	150	45	
MD-R-AXBR 2525-05.75	25	25	25	65-130	19	5	150	45	
MD-R-AXBR 2525-05.130	25	25	25	120-200	19	5	150	45	
MD-R-AXBR 2525-05.200	25	25	25	190-450	19	5	150	45	
MD-R-AXBR 2525-05.450	25	25	25	440-∞	19	5	150	45	

Ersatzteile Schraube M6; Schlüssel I5

Spare Parts Screw M6; Key I5

# Axial- Einstechdrehen

## Face grooving

# MD-R90-AXBL

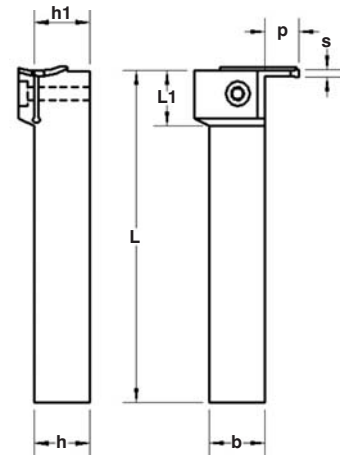

Bestell-Nr. Order No.	Abmessungen - Dimension (mm)								Wendeplatte Insert
	h	h <sub>1</sub>	b	D <sub>min</sub> -D <sub>max</sub>	p	s	L	L <sub>1</sub>	
MD-R90-AXBL 2020 -03.25	20	20	20	19-30	15	3	125	25	MD 22..
MD-R90-AXBL 2020 -03.30	20	20	20	24-35	15	3	125	25	
MD-R90-AXBL 2020 -03.35	20	20	20	29-42	15	3	125	25	
MD-R90-AXBL 2020 -03.42	20	20	20	36-50	15	3	125	25	
MD-R90-AXBL 2020 -03.50	20	20	20	44-58	15	3	125	25	
MD-R90-AXBL 2020 -03.58	20	20	20	52-66	15	3	125	25	
MD-R90-AXBL 2020 -03.66	20	20	20	60-75	15	3	125	25	
MD-R90-AXBL 2020 -03.75	20	20	20	69-100	15	3	125	25	
MD-R90-AXBL 2020 -04.42	20	20	20	34-50	15	4	125	25	
MD-R90-AXBL 2020 -04.50	20	20	20	42-58	15	4	125	25	
MD-R90-AXBL 2020 -04.58	20	20	20	50-66	15	4	125	25	
MD-R90-AXBL 2020 -04.66	20	20	20	58-75	15	4	125	25	
MD-R90-AXBL 2020 -04.75	20	20	20	67-100	15	4	125	25	
MD-R90-AXBL 2020 -04.100	20	20	20	92-200	15	4	125	25	
MD-R90-AXBL 2020 -05.42	20	20	20	32-50	15	5	125	25	
MD-R90-AXBL 2020 -05.50	20	20	20	40-58	15	5	125	25	
MD-R90-AXBL 2020 -05.58	20	20	20	48-66	15	5	125	25	
MD-R90-AXBL 2020 -05.66	20	20	20	56-75	15	5	125	25	
MD-R90-AXBL 2020 -05.75	20	20	20	65-100	15	5	125	25	
MD-R90-AXBL 2020 -05.100	20	20	20	90-200	15	5	125	25	
MD-R90-AXBL 2525 -03.25	25	25	25	19-30	15	3	150	25	MD 22..
MD-R90-AXBL 2525 -03.30	25	25	25	24-35	15	3	150	25	
MD-R90-AXBL 2525 -03.35	25	25	25	29-42	15	3	150	25	
MD-R90-AXBL 2525 -03.42	25	25	25	36-50	15	3	150	25	
MD-R90-AXBL 2525 -03.50	25	25	25	44-58	15	3	150	25	
MD-R90-AXBL 2525 -03.58	25	25	25	52-66	15	3	150	25	
MD-R90-AXBL 2525 -03.66	25	25	25	60-75	15	3	150	25	
MD-R90-AXBL 2525 -03.75	25	25	25	69-100	15	3	150	25	
MD-R90-AXBL 2525 -04.42	25	25	25	34-50	15	4	150	25	
MD-R90-AXBL 2525 -04.50	25	25	25	42-58	15	4	150	25	
MD-R90-AXBL 2525 -04.58	25	25	25	50-66	15	4	150	25	
MD-R90-AXBL 2525 -04.66	25	25	25	58-75	15	4	150	25	
MD-R90-AXBL 2525 -04.75	25	25	25	67-100	15	4	150	25	
MD-R90-AXBL 2525 -04.100	25	25	25	92-200	15	4	150	25	
MD-R90-AXBL 2525 -05.42	25	25	25	32-52	15	5	150	25	
MD-R90-AXBL 2525 -05.50	25	25	25	40-58	15	5	150	25	
MD-R90-AXBL 2525 -05.58	25	25	25	48-66	15	5	150	25	
MD-R90-AXBL 2525 -05.66	25	25	25	56-75	15	5	150	25	
MD-R90-AXBL 2525 -05.75	25	25	25	65-100	15	5	150	25	
MD-R90-AXBL 2525 -05.100	25	25	25	90-200	15	5	150	25	

Ersatzteile Schraube M6; Schlüssel I5

Spare Parts Screw M6; Key I5

Wendeplatten Seite 16

# MD-R90-AXBR

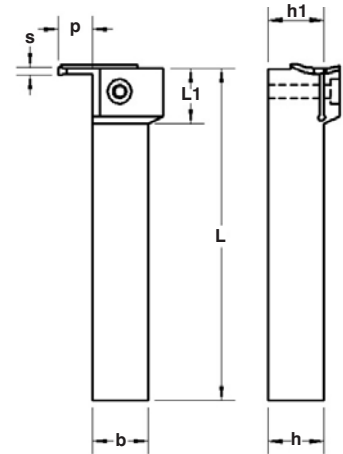

Bestell-Nr. Order No.	Abmessungen - Dimension (mm)								Wendeplatte Insert	
	h	h <sub>1</sub>	b	D <sub>min</sub> -D <sub>max</sub>	p	s	L	L <sub>1</sub>		
MD-R90-AXBR 2020 -03.25	20	20	20	19-30	15	3	125	25	MD 22..	
MD-R90-AXBR 2020 -03.30	20	20	20	24-35	15	3	125	25		
MD-R90-AXBR 2020 -03.35	20	20	20	29-42	15	3	125	25		
MD-R90-AXBR 2020 -03.42	20	20	20	36-50	15	3	125	25		
MD-R90-AXBR 2020 -03.50	20	20	20	44-58	15	3	125	25		
MD-R90-AXBR 2020 -03.58	20	20	20	52-66	15	3	125	25		
MD-R90-AXBR 2020 -03.66	20	20	20	60-75	15	3	125	25		
MD-R90-AXBR 2020 -03.75	20	20	20	69-100	15	3	125	25		
MD-R90-AXBR 2020 -04.42	20	20	20	34-50	15	4	125	25	MD 24..	
MD-R90-AXBR 2020 -04.50	20	20	20	42-58	15	4	125	25		
MD-R90-AXBR 2020 -04.58	20	20	20	50-66	15	4	125	25		
MD-R90-AXBR 2020 -04.66	20	20	20	58-75	15	4	125	25		
MD-R90-AXBR 2020 -04.75	20	20	20	67-100	15	4	125	25		
MD-R90-AXBR 2020 -04.100	20	20	20	92-200	15	4	125	25		
MD-R90-AXBR 2020 -05.42	20	20	20	32-50	15	5	125	25		
MD-R90-AXBR 2020 -05.50	20	20	20	40-58	15	5	125	25		
MD-R90-AXBR 2020 -05.58	20	20	20	48-66	15	5	125	25	MD 24..	
MD-R90-AXBR 2020 -05.66	20	20	20	56-75	15	5	125	25		
MD-R90-AXBR 2020 -05.75	20	20	20	65-100	15	5	125	25		
MD-R90-AXBR 2020 -05.100	20	20	20	90-200	15	5	125	25		
MD-R90-AXBR 2525 -03.25	25	25	25	19-30	15	3	150	25		MD 22..
MD-R90-AXBR 2525 -03.30	25	25	25	24-35	15	3	150	25		
MD-R90-AXBR 2525 -03.35	25	25	25	29-42	15	3	150	25		
MD-R90-AXBR 2525 -03.42	25	25	25	36-50	15	3	150	25		
MD-R90-AXBR 2525 -03.50	25	25	25	44-58	15	3	150	25		
MD-R90-AXBR 2525 -03.58	25	25	25	52-66	15	3	150	25		
MD-R90-AXBR 2525 -03.66	25	25	25	60-75	15	3	150	25		
MD-R90-AXBR 2525 -03.75	25	25	25	69-100	15	3	150	25		
MD-R90-AXBR 2525 -04.42	25	25	25	34-50	15	4	150	25	MD 24..	
MD-R90-AXBR 2525 -04.50	25	25	25	42-58	15	4	150	25		
MD-R90-AXBR 2525 -04.58	25	25	25	50-66	15	4	150	25		
MD-R90-AXBR 2525 -04.66	25	25	25	58-75	15	4	150	25		
MD-R90-AXBR 2525 -04.75	25	25	25	67-100	15	4	150	25		
MD-R90-AXBR 2525 -04.100	25	25	25	92-200	15	4	150	25		
MD-R90-AXBR 2525 -05.42	25	25	25	32-50	15	5	150	25		
MD-R90-AXBR 2525 -05.50	25	25	25	40-58	15	5	150	25		
MD-R90-AXBR 2525 -05.58	25	25	25	48-66	15	5	150	25	MD 24..	
MD-R90-AXBR 2525 -05.66	25	25	25	56-75	15	5	150	25		
MD-R90-AXBR 2525 -05.75	25	25	25	65-100	15	5	150	25		
MD-R90-AXBR 2525 -05.100	25	25	25	90-200	15	5	150	25		



Ersatzteile Schraube M6; Schlüssel I5

Spare Parts Screw M6; Key I5

Wendeplatten Seite 16

# Axial- Einstechdrehen

## Face grooving

Bestell-Nr. Order No.	Abmessungen - Dimension (mm)					PVD-TIALN	PVD-TIALN	CVD
	Bezeichnung Designation	Länge length	Breite width	Radius	ap max.	KTE20	PTV28	PTT28
	MD 22N 3.00S-0.30-T	22.0	3.00	0.30	2.50	●	●	●
	MD 24N 4.00S-0.40-T	24.0	4.00	0.40	3.00	●	●	●
	MD 24N 5.00S-0.40-T	24.0	5.00	0.40	3.50	●	●	●
	MD 22N 3.00S-1.50-R	22.0	3.00	1.50	3.00	●	●	●
	MD 24N 4.00S-2.00-R	24.0	4.00	2.00	4.00	●	●	●

Einsatzbeispiele für Axial- Einstechdrehen  
Examples for face grooving

### MD-R-AXBL 2525 -03

Plattenbreite  
width of insert

Linkslauf  
turning left

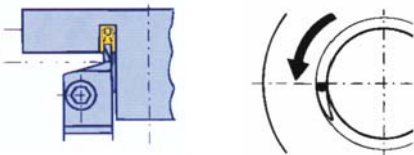

### MD-R90-AXBL 2525 -03

Plattenbreite  
width of insert

Rechtslauf  
turning right

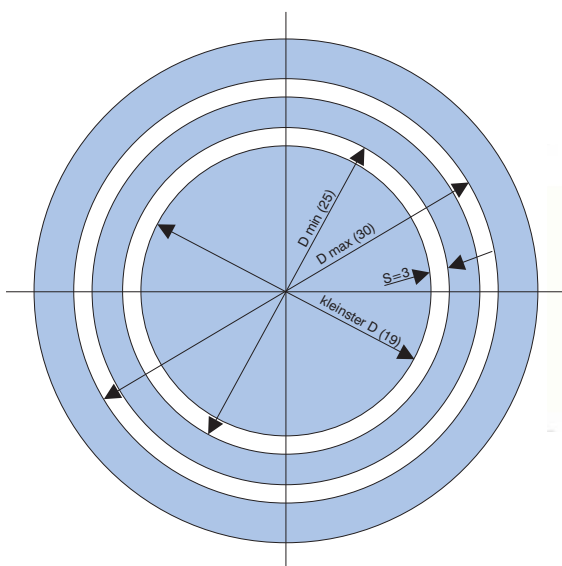
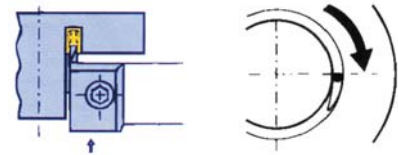

Zum Beispiel:

1. bei Fertigung von Dmin 19mm wird Bearbeitungsdurchmesser 25mm programmiert.
2. bei Fertigung von Dmax 30mm wird Bearbeitungsdurchmesser 24mm programmiert.

For Example:

1. By production of Dmin 19mm is programmed working diameter 25mm
2. By production of Dmax 30mm is programmed working diameter 25mm



# Einsteck- und Längsdrehen (Innen)

## Grooving and turning (internal)

### MD-IXBL

WP M10..

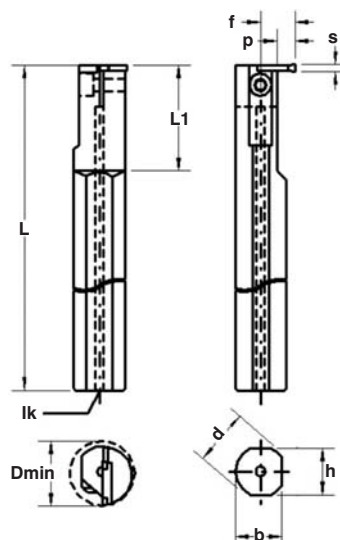

Made in Germany

Bestell-Nr. Order No.	Abmessungen - Dimension (mm)										Wendeplatte Insert
	D <sub>min</sub>	d	h	b	f	s	p	L	L <sub>1</sub>		
MD-IXBL 0012 -02	15,5	12	11	11,5	8,7	2	3	150	22	M10..	
MD-IXBL 0012 -03	15,5	12	11	11,5	8,7	3	3	150	22		
MD-IXBL 0016 -02	20	16	15	15,5	11	2	4	170	26		
MD-IXBL 0016 -03	20	16	15	15,5	11	3	4	170	26		
MD-IXBL 0020 -02	25	20	18	18,5	13	2	7	180	40		
MD-IXBL 0020 -02,5	25	20	18	18,5	13	2,5	7	180	40		
MD-IXBL 0020 -03	25	20	18	18,5	13	3	7	180	40		
MD-IXBL 0025 -02	32	25	23	23	17	2	10	180	50	MD 22..	
MD-IXBL 0025 -02,5	32	25	23	23	17	2,5	10	180	50		
MD-IXBL 0025 -03	32	25	23	23	17	3	10	180	50	MD 24..	
MD-IXBL 0025 -04	32	25	23	23	17	4	10	180	50	MD 22..	
MD-IXBL 0032 -03	40	32	30	30	22	3	12	200	64	MD 24..	
MD-IXBL 0032 -04	40	32	30	30	22	4	12	200	64		
MD-IXBL 0032 -05	40	32	30	30	22	5	12	200	64		
MD-IXBL 0040 -04	52	40	38	38	30	4	16	250	80		
MD-IXBL 0040 -05	52	40	38	38	30	5	16	250	80		
MD-IXBL 0040 -06	52	40	38	38	30	6	16	250	80		

Ersatzteile Halter ..0012: Schraube M4; Schlüssel I3;  
Halter ab ..0025: Schraube M6; Schlüssel I5

Spare Parts Tool ..0012: Screw M4; Key I3;  
Tool ab ..0025: Screw M6; Key I5

Bestell-Nr. Order No.	Bezeichnung Designation	Abmessungen - Dimension (mm)				PVD-TIALN	PVD-TIALN	CVD
		Länge length	Breite width	Radius	ap max.	KTE20	PTV28	PTT28
	M 10N 2.00S-0.20-T	10.0	2.00	0.20	1.50	●	●	●
	M 10N 2.50S-0.20-T	10.0	2.50	0.20	2.00	●	●	●
	M 10N 3.00S-0.30-T	10.0	3.00	0.30	2.50	●	●	●
	MD 22N 2.00S-0.20-T	22.0	2.00	0.20	1.50	●	●	●
	MD 22N 2.50S-0.20-T	22.0	2.50	0.20	2.00	●	●	●
	MD 22N 3.00S-0.30-T	22.0	3.00	0.30	2.50	●	●	●
	MD 24N 4.00S-0.40-T	24.0	4.00	0.40	3.00	●	●	●
	MD 24N 5.00S-0.40-T	24.0	5.00	0.40	3.50	●	●	●
	MD 24N 6.00S-0.40-T	24.0	6.00	0.40	4.00	●	●	●
	M 10N 3.00S-1.50-R	10.0	3.00	1.50	3.00	●	●	●
	MD 22N 3.00S-1.50-R	22.0	3.00	1.50	3.00	●	●	●
	MD 24N 4.00S-2.00-R	24.0	4.00	2.00	4.00	●	●	●
	MD 24N 6.00S-3.00-R	24.0	6.00	3.00	5.00	●	●	●

# Einsteck- und Längsdrehen (Innen)

## Grooving and turning (internal)

### MD-IXBR

WP M10..



Made in Germany

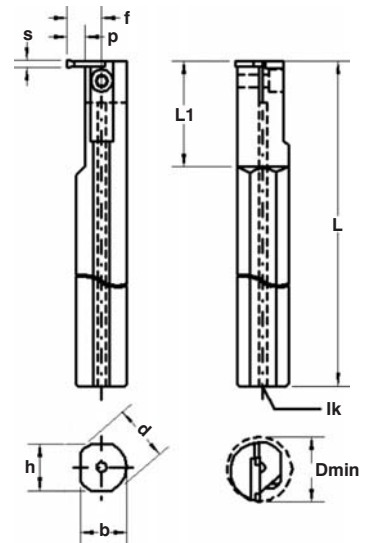

Bestell-Nr. Order No.	Abmessungen - Dimension (mm)										Wendeplatte Insert
	D <sub>min</sub>	d	h	b	f	s	p	L	L <sub>1</sub>		
MD-IXBR 0012 -02	15,5	12	11	11,5	8,7	2	3	150	22	M10..	
MD-IXBR 0012 -03	15,5	12	11	11,5	8,7	3	3	150	22		
MD-IXBR 0016 -02	20	16	15	15,5	11	2	4	170	26		
MD-IXBR 0016 -03	20	16	15	15,5	11	3	4	170	26		
MD-IXBR 0020 -02	25	20	18	18,5	13	2	7	180	40		
MD-IXBR 0020 -02,5	25	20	18	18,5	13	2,5	7	180	40		
MD-IXBR 0020 -03	25	20	18	18,5	13	3	7	180	40		
MD-IXBR 0025 -02	32	25	23	23	17	2	10	180	50		
MD-IXBR 0025 -02,5	32	25	23	23	17	2,5	10	180	50		
MD-IXBR 0025 -03	32	25	23	23	17	3	10	180	50		
MD-IXBR 0025 -04	32	25	23	23	17	4	10	180	50		
MD-IXBR 0032 -03	40	32	30	30	22	3	12	200	64		
MD-IXBR 0032 -04	40	32	30	30	22	4	12	200	64		
MD-IXBR 0032 -05	40	32	30	30	22	5	12	200	64		
MD-IXBR 0040 -04	52	40	38	38	30	4	16	250	80		
MD-IXBR 0040 -05	52	40	38	38	30	5	16	250	80		
MD-IXBR 0040 -06	52	40	38	38	30	6	16	250	80		

Ersatzteile Halter ..0012: Schraube M4; Schlüssel I3;  
Halter ab ..0025: Schraube M6; Schlüssel I5

Spare Parts Tool ..0012: Screw M4; Key I3;  
Tool ab ..0025: Screw M6; Key I5

Bestell-Nr. Order No.	Bezeichnung Designation	Abmessungen - Dimension (mm)				PVD-TIALN	PVD-TIALN	CVD
		Länge length	Breite width	Radius	ap max.	KTE20	PTV28	PTT28
	M 10N 2.00S-0.20-T	10.0	2.00	0.20	1.50	●	●	●
	M 10N 2.50S-0.20-T	10.0	2.50	0.20	2.00	●	●	●
	M 10N 3.00S-0.30-T	10.0	3.00	0.30	2.50	●	●	●
	MD 22N 2.00S-0.20-T	22.0	2.00	0.20	1.50	●	●	●
	MD 22N 2.50S-0.20-T	22.0	2.50	0.20	2.00	●	●	●
	MD 22N 3.00S-0.30-T	22.0	3.00	0.30	2.50	●	●	●
	MD 24N 4.00S-0.40-T	24.0	4.00	0.40	3.00	●	●	●
	MD 24N 5.00S-0.40-T	24.0	5.00	0.40	3.50	●	●	●
	MD 24N 6.00S-0.40-T	24.0	6.00	0.40	4.00	●	●	●
	M 10N 3.00S-1.50-R	10.0	3.00	1.50	3.00	●	●	●
	MD 22N 3.00S-1.50-R	22.0	3.00	1.50	3.00	●	●	●
	MD 24N 4.00S-2.00-R	24.0	4.00	2.00	4.00	●	●	●
	MD 24N 6.00S-3.00-R	24.0	6.00	3.00	5.00	●	●	●

## Schnittgeschwindigkeiten vc Cutting speeds vc

Arbeitsmaterial Material-groups	HM-Qualitäten Carbides quality	Vc
Einfachbearbeitungs- Kohlenstahl <i>Easy to work carbon steel</i>	<b>PTT28</b> <b>PTV28</b>	100 - 240
Flussstahl - Edelstahl <i>Cast steel - alloyed steel</i>	<b>PTT28</b> <b>PTV28</b>	80 - 160
Werkzeugstahl <i>Steel for tools</i>	<b>PTT28</b> <b>PTV28</b>	100 - 180
Martensit-Ferriter Rostfreier Stahl AISI400 <i>Martensitic and ferritic stainless steel AISI400</i>	<b>PTT28</b> <b>PTV28</b>	120 - 150
Austenitischer Rostfreier Stahl - Serie AISI300 <i>Austenitic stainless steel AISI300</i>	<b>PTT28</b> <b>PTV28</b>	80 - 110
Grauguss <i>Gray cast iron</i>	<b>PTV28</b>	100 - 160
Sphäroguss <i>Spheroidal cast iron</i>	<b>PTV28</b>	100 - 150
Eisenfreies Material Kupfer - Gelbguss <i>Non ferrous material -copper, brass</i>	<b>KTE20</b>	80 - 180
Aluminiumlegierung <i>Aluminium alloy</i>	<b>KTE20</b>	300 - 600

## Vorschub pro Umdrehung f

## Feed per rotation f

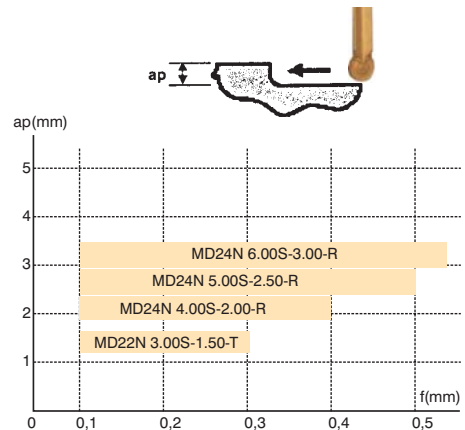
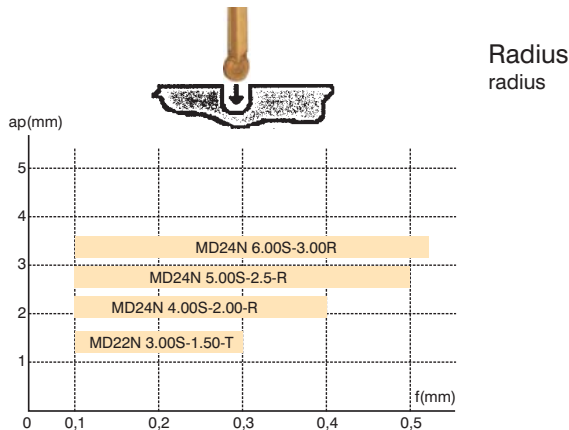
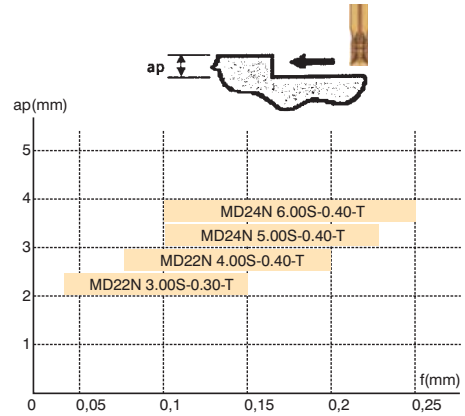
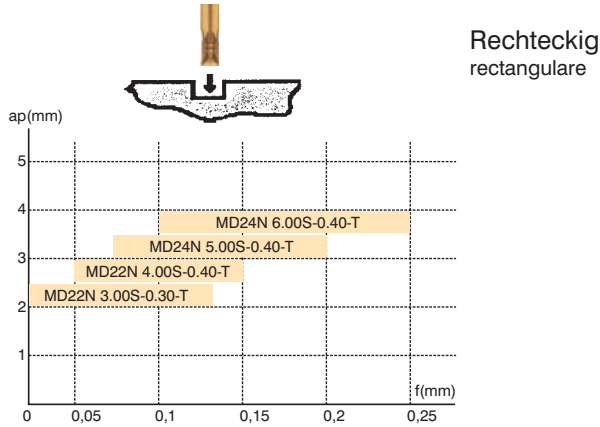

Die Vorschubwerte für Einsätze M10.. sind identisch mit den Einsätzen MD22..  
 The feedrates of M10.. are available with MD22..

## Nomenklatur und Formeln

### Nomenclatura and Formulae

#### Schnittgeschwindigkeit und Drehzahl

Cutting speed and revolution

$$v_c = \frac{n \cdot \pi \cdot D_w}{1000} \quad (\text{m/min})$$

$$n = \frac{v_c \cdot 1000}{\pi \cdot D_w} \quad (\text{U/min})$$

#### ap

Axiale Schnitttiefe  
 axial cutting depth (mm)

#### Dc

Durchmesser  
 Cutter diameter (mm)

#### f

Vorschub pro Umdrehung  
 feed per rotation (mm/U)  
 (mm/rpm)

#### n

Drehzahl  
 revolution speed (U/min)  
 (rpm)

## ISO

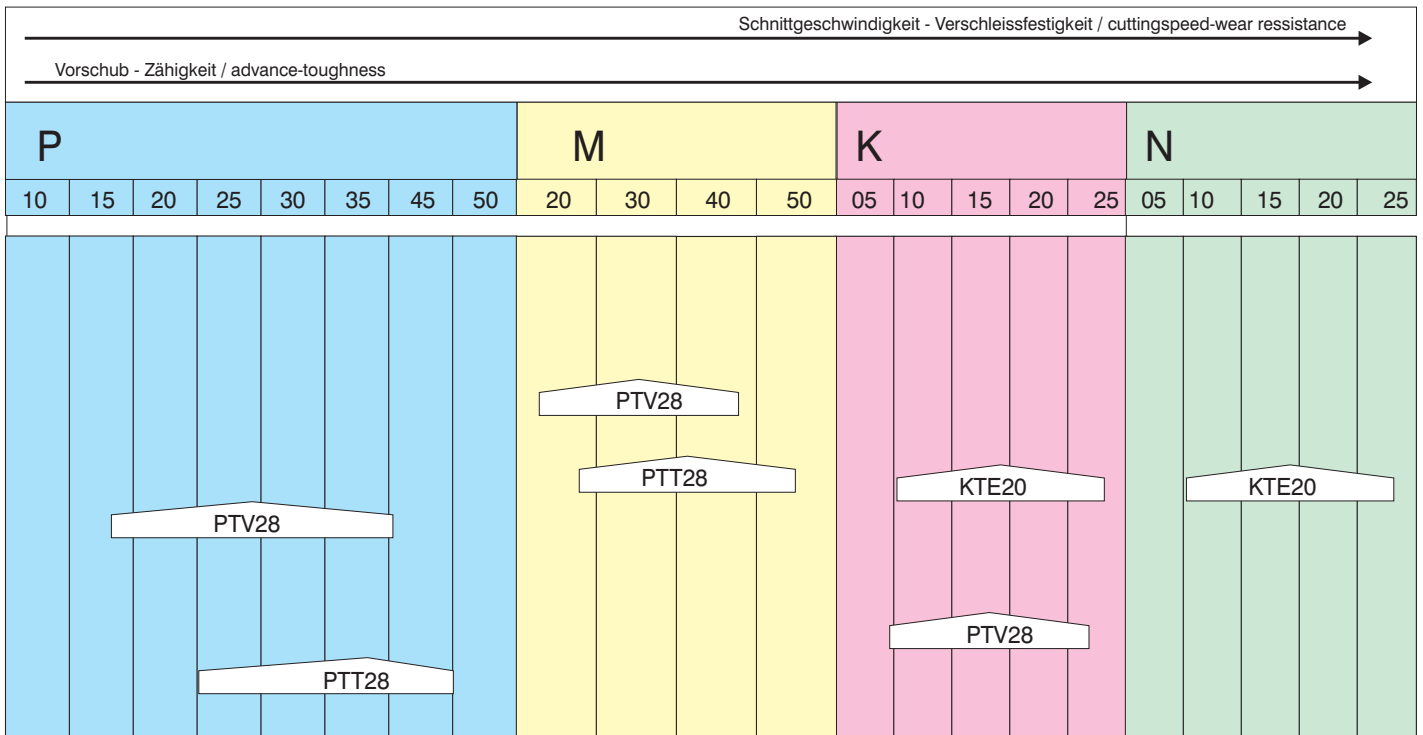

<b>Stahl</b> Steel	P	20	PTV28
		25	
<b>Rostfreier Stahl</b> Stainless steel	M	20	PTV28
		30	
		40	PTT28
<b>Grauguss / Cast iron</b>	K	10-15	KTE20
		GG..	
<b>Sphäroguss</b> Spheroidal cast iron	K	20-25	KTE20, PTV28
		GGG..	
<b>Leichtmetall</b> Light alloys	N	10-15	KTE20
		20-25	KTE20
<b>Exotische Materialien</b> Exotics	N	10-15	KTE20
		20-25	KTE20

PTT28	TIN-TICN-TIN beschichtet / TIN-TICN-TINcoated
PTV28	TIALN-beschichtet / TIALN-coated
KTE20	TIALN-beschichtet / TIALN-coated

## Bearbeitung zwischen den Schultern side turning between shoulders

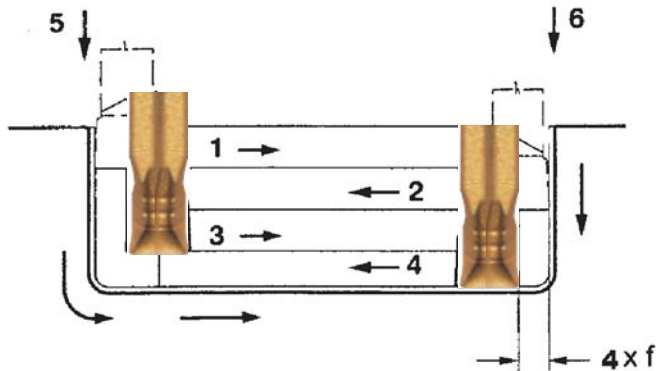

▽ Schnitt / cut 1 - 4

▽▽ Schnitt / cut 5 - 6

Beim Längsdrehen ist stets an der Schulter zu beginnen.

Beim Auskammern empfehlen wir wie gezeigt vorzugehen. Der 2. Schnitt und folgende erfordern einen Abstand von  $4 \times f$ .

Always start at the shoulder when side-turning.

Grooving and turning is recommended as shown. The second cut and following leave a distance of  $4 \times f$ .

## Fasen von Nuten mit Standard-Schneidplatten

Groove chamfering  
 with standard inserts

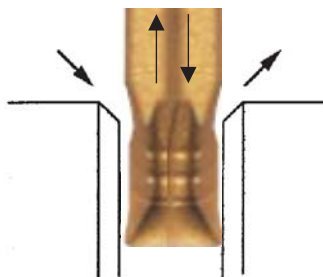

**Nut = Schneidbreite**  
 width of groove = width of insert

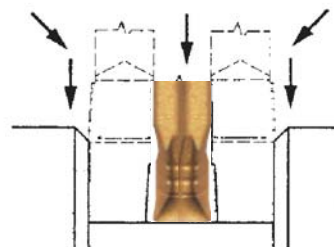

**Nut > Schneidbreite**  
 width of groove > width of insert



**MAIER**  
**HEAD-Master**  
  
**MILLING**  
**FRÄSWERKZEUGE**

**MAIER**  
**HEAD-Master**  
  
*3D Bohr-Zirkularfräse*  
**F-2010**

**MAIER**  
**HEAD-Master**  
  
**MOULDMILL**  
**Werkzeug- & Formenbau**

**MAIER**  
**HEAD-Master**  
  
**FACE & CHAMFER MILLING**  
**Senk- & Faswerkzeuge**

**MAIER**  
**HEAD-Master**  
  
**DRILLING**  
**BOHRWERKZEUGE**

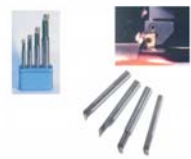
**MAIER**  
**HEAD-Master**  
  
**TURNING**  
**DREHWERKZEUGE**

**MAIER**  
**HEAD-Master**  
  
**HDBORING-BARS**  
**HD-BOHRSTANGEN**

**MAIER**  
**HEAD-Master**  
  
**SOLID CARBIDE TOOLS**  
**VHM-WERKZEUGE**

**MAIER**  
**HEAD-Master**  
  
**GROOVING TOOLS**  
**STECHWERKZEUGE**



Oberpiebing  
 Dorfstraße 14  
 D-94330 Salching

Tel.: +49 (0)9426 - 80 26 50  
 Fax: +49 (0)9426 - 80 26 51

e-mail: [info@maier-tools.de](mailto:info@maier-tools.de)  
[www.maier-tools.com](http://www.maier-tools.com)