

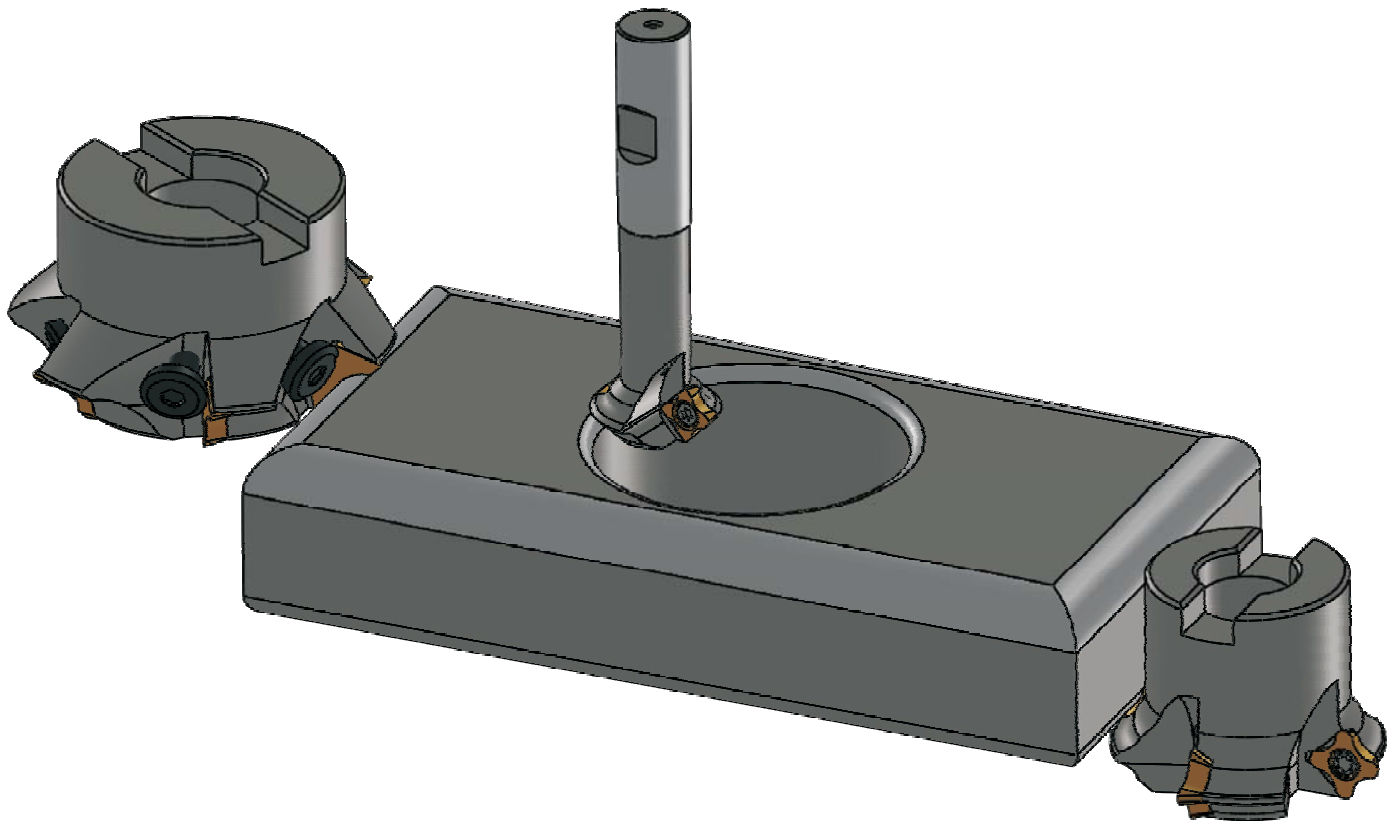

HEAD[®]-Master



THE TOOLS

Radius- Chamferingtools

Radien- Faswerkzeuge

Fräser für konvexe Radien an Außen-Ø oder Bohrungen

Cutter for convex radius on outside-Ø or holes

3016

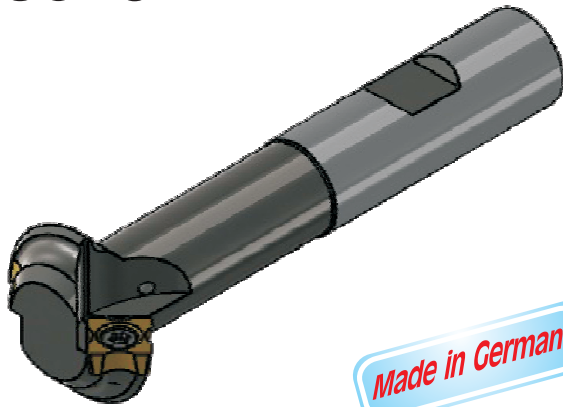

Made in Germany

Ausführung: Fräser für konvexe Radien an Außen-Ø oder Bohrungen
Lieferumfang: ohne Wendeschneidplatte, ohne Schraubendreher
Anwendung: universeller Einsatz zum Fräsen von konvexen Radien

Execution: Milling cutter for radius on outside-Ø or holes
Delivery: without insert, without screwdriver
Application: universal application for milling convex radius

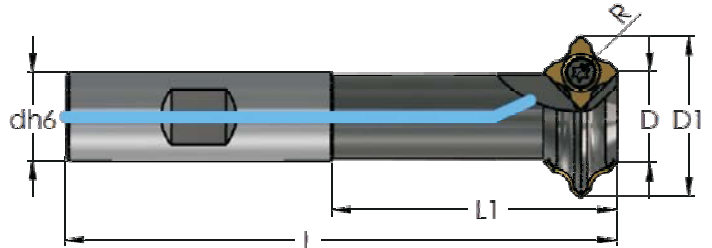

NEU / NEW

Bestell-Nr./Order No.	Abmessungen - Dimension (mm)						Wendeplatte insert	Wpl.-schraube insert screw	Torxschlüssel key
	D	D1	L	L1	Ødh6	Z			
3016									
012 W-W	12	23,7	100	50	16	1	SCXT 09T3 R..	M-VT 40-6	M-BT 15
012 WL	12	23,7	200	50	16	1			
016 W-W	16	28,8	100	50	16	2			
016 WL	16	28,8	200	50	16	2			
025 W-W	28	40,3	100	45	25	3	SEXT 1204 R..	M-VT 45	M-BT 20
025 WL	28	40,3	200	45	25	3			
025 W-W-12	28	40,5	100	45	25	3			
025 WL-12	28	40,5	200	45	25	3			
032 W-W	32	45,0	100	45	25	3			
032 WL	32	45,0	200	45	25	3			

W-W = Kühlmittelbohrung / coolant bores

Bestellbeispiel / Order example: 3016-012W-W

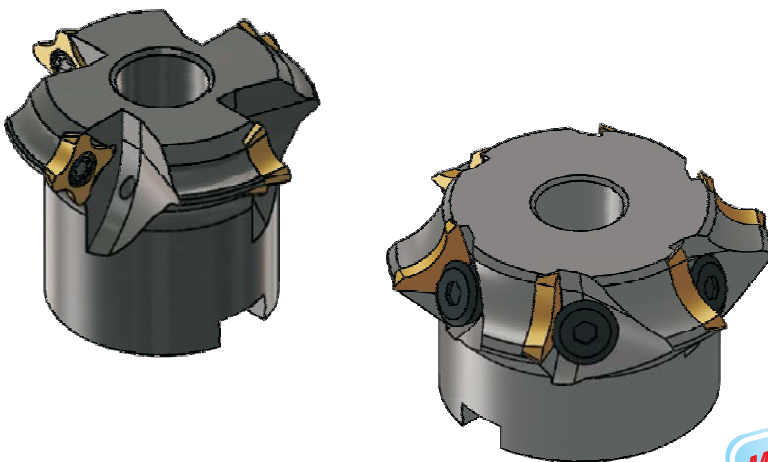

Made in Germany

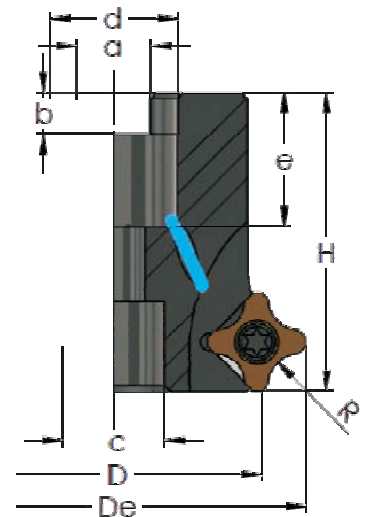

NEU / NEW

Bestell-Nr./Order No.	Abmessungen - Dimension (mm)									Wendeplatte insert	Wpl.-schraube insert screw	Torxschlüssel key
	D	De	d	c	e	a	b	H	z			
3016												
M-W D32	32	45	16	14	18	8,4	5,6	40	3	SEXT 1204 R..	M-VT 45	M-BT 20
M-W D40	40	53	16	14	18	8,4	5,6	40	4			
M-W D50	50	63	22	17	21	10,4	6,3	48	5			
M-W D63	63	92,5	22	19	21	10,4	6,3	48	6	XPKN 2204 R..	M-CVB55	M-CL2

M-W = Kühlmittelbohrung / M-W = coolant bores

Bestellbeispiel / Orderexample: 3016 M-W D32

Fasenfräser

Milling cutter for chamfering

Ausführung: Fasfräser , mit Innenkühlung
Lieferumfang: ohne Wendeschneidplatte, ohne Schraubendreher
Anwendung: zum Fasenfräsen und Kantenfräsen

3012

Execution: Milling cutter for chamfering and centering , with inner coolant
Delivery: without insert, without screwdriver
Application: for face milling

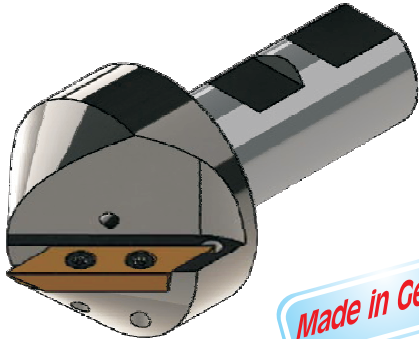

Made in Germany

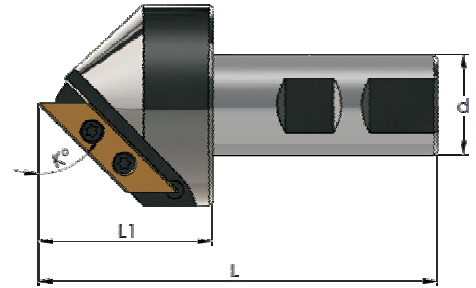
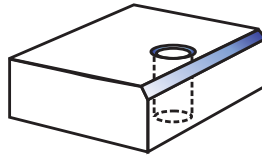

NEU / NEW





Bestell-Nr./Order No.	Abmessungen - Dimension (mm)						Wendepatte insert	Wpl.-schraube insert screw	Torxschlüssel key
	L	L1	Dmin-Dmax	dh6	K°	z			
3012									
W-W 30°	120	50	5 - 57	25	30	2	LCEX 310404	M-VT40	M-BT15
W-W 45°	120	50	5 - 48	25	45	2	LCEX 310404	M-VT40	M-BT15
W-W 60°	120	50	5 - 35	25	60	1	LCEX 310404	M-VT40	M-BT15

W-W = Kühlmittelbohrung
W-W = coolant bores

Bestellbeispiel / Order example: 3012 W-W 30°

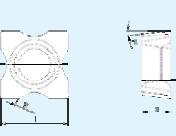
Wendepplatten

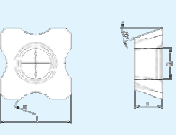
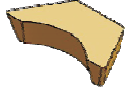
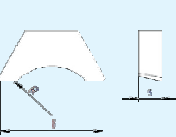
Inserts

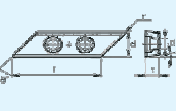
	Form Figure	Abmessungen Dimensions					Bezeichnung Designation	Beschichtete Sorten- coated grades														
		l	d	s	d1	R		Unbeschichtete Sorten- uncoated			Beschichtete Sorten- coated grades											
								CT28	K10		MTM10	PTT20	PTT35	KTE20	PTV28	PTES5						
 <p>NEU / NEW SCXT 09T3 R..</p>		9,52	3,97		1,0																	
		9,52	3,97		2,0																	
		9,52	3,97		3,0																	
 <p>NEU / NEW SEXT 1204 R..</p>		12,70	4,76		1,0																	
		12,70	4,76		2,0																	
		12,70	4,76		3,0																	
		12,70	4,76		4,0																	
		12,70	4,76		5,0																	
 <p>NEU / NEW XPKN 2204 R..</p>		21,0	4,76		6,0																	
		21,0	4,76		7,0																	
		21,0	4,76		8,0																	
		21,0	4,76		10,0																	
 <p>NEU / NEW</p>		30,9	9,53	4,50	4,4	0,40																
		30,9	9,53	4,50	4,4	0,40																

■ Lieferbar in stock □ auf Anfrage on request

Technische Daten

Technical data

Werkzeugtypen

Tool-types

Arbeitsmaterial Material-groups	HM-Qualitäten Carbides quality	3016		3012	
		Vc	fz	Vc	fz
Einfachbearbeitungs- Kohlenstahl <i>Easy to work carbon steel</i>	PTV28 PTT35	170	0,10 0,20	170	0,10 0,20
Flussstahl - Edelstahl <i>Cast steel - alloyed steel</i>	PTV28 PTT35	150	0,10 0,20	150	0,10 0,20
Werkzeugstahl <i>Steel for tools</i>	PTV28 PTT35	110	0,10 0,20	110	0,10 0,20
Martensit-Ferriter Rostfreier Stahl AISI400 <i>Martensitic and ferritic stainless steel AISI400</i>	PTV28 PTT35	140	0,10 0,20	140	0,10 0,20
Austenitischer Rostfreier Stahl - Serie AISI300 <i>Austenitic stainless steel AISI300</i>	PTV28 PTT35	110	0,10 0,20	110	0,10 0,20
Grauguss <i>Gray cast iron</i>	MTM10	120	0,12 0,20	120	0,12 0,20
Sphäroguss <i>Spheroidal cast iron</i>	PTV28 PTT35	120	0,10 0,20	120	0,10 0,20
Eisenfreies Material Kupfer - Gießguss <i>Non ferrous material -copper, brass</i>	K10 KTE20	140	0,12 0,20	140	0,12 0,20
Aluminiumlegierung <i>Aluminium alloy</i>	K10 KTE20	400	0,12 0,20	400	0,12 0,20

Preise / Prices

EURO

3012 W-W 30°	S	196,56
3012 W-W 45°	S	196,56
3012 W-W 60°	S	196,56
3016-012WL	S	145,00
3016-012W-W	S	145,00
3016-016WL	S	185,00
3016-016W-W	S	185,00
3016-025WL	S	199,00
3016-025W-W	S	199,00
3016-025WL-12	S	199,00
3016-025W-W-12	S	199,00
3016-032WL	S	199,00
3016-032W-W	S	199,00
3016 M-W D32	S	202,00
3016 M-W D40	S	202,00
3016 M-W D50	S	245,00
3016 M-W D63	S	289,00
LCEX 310404 WF PTV28	WS	98,00
LCEX 310404 WM PTV28	WS	108,00
SCXT 09T3 R1 KTE20	WS	25,00
SCXT 09T3 R1 MTM10	WS	25,00
SCXT 09T3 R1 PTV28	WS	25,00
SCXT 09T3 R1 PTT35	WS	25,00
SCXT 09T3 R2 KTE20	WS	25,00
SCXT 09T3 R2 MTM10	WS	25,00
SCXT 09T3 R2 PTV28	WS	25,00
SCXT 09T3 R2 PTT35	WS	25,00
SCXT 09T3 R3 KTE20	WS	25,00
SCXT 09T3 R3 MTM10	WS	25,00
SCXT 09T3 R3 PTV28	WS	25,00
SCXT 09T3 R3 PTT35	WS	25,00
SEXT 1204 R1 KTE20	WS	28,00
SEXT 1204 R1 MTM10	WS	28,00
SEXT 1204 R1 PTV28	WS	28,00
SEXT 1204 R1 PTT35	WS	28,00
SEXT 1204 R2 KTE20	WS	28,00
SEXT 1204 R2 MTM10	WS	28,00
SEXT 1204 R2 PTV28	WS	28,00
SEXT 1204 R2 PTT35	WS	28,00
SEXT 1204 R3 KTE20	WS	28,00
SEXT 1204 R3 MTM10	WS	28,00
SEXT 1204 R3 PTV28	WS	28,00
SEXT 1204 R3 PTT35	WS	28,00
SEXT 1204 R4 KTE20	WS	28,00
SEXT 1204 R4 MTM10	WS	28,00
SEXT 1204 R4 PTV28	WS	28,00
SEXT 1204 R4 PTT35	WS	28,00
SEXT 1204 R5 KTE20	WS	28,00
SEXT 1204 R5 MTM10	WS	28,00
SEXT 1204 R5 PTV28	WS	28,00
SEXT 1204 R5 PTT35	WS	28,00
XPKN 2204 R6 KTE20	WS	18,00
XPKN 2204 R6 MTM10	WS	18,00
XPKN 2204 R6 PTV28	WS	18,00
XPKN 2204 R6 PTT35	WS	18,00
XPKN 2204 R7 KTE20	WS	18,00
XPKN 2204 R7 MTM10	WS	18,00
XPKN 2204 R7 PTV28	WS	18,00
XPKN 2204 R7 PTT35	WS	18,00
XPKN 2204 R8 KTE20	WS	18,00
XPKN 2204 R8 MTM10	WS	18,00
XPKN 2204 R8 PTV28	WS	18,00
XPKN 2204 R8 PTT35	WS	18,00
XPKN 2204 R10 KTE20	WS	18,00
XPKN 2204 R10 MTM10	WS	18,00
XPKN 2204 R10 PTV28	WS	18,00
XPKN 2204 R10 PTT35	WS	18,00

Die o.g. Daten sind als Empfehlungswerte zu betrachten.
The above data are approximate.



Oberpiebing
Dorfstraße 14
D-94330 Salching

Tel.: +49 (0)9426 - 80 26 50
Fax: +49 (0)9426 - 80 26 51

e-mail: info@maier-tools.de
www.maier-tools.com